

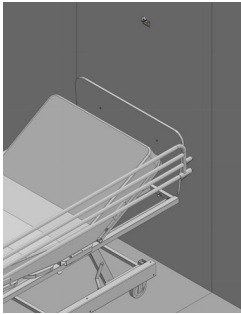

1. Set mounting height



The AURA is designed to be mounted at, or above the mean 'eye height' of the staff, thus reducing glare in the work place. We recommend a mounting height of 1700mm for the Australian market - however this should be decided and approved through consultation on a project specific basis. This height should be measured from the floor to the centre of the cable access hole in the back plate.

2. Plug into power outlet in wall cavity



3. Position/Level/Fix back plate



Position, level and fix the back plate:

- Height to top edge of back plate is "install height" + 40mm
- Centre of light fitting should be positioned over the centerline of the bed location.
- Locate and fix one of the slotted holes provided (contractor is responsible for selecting a suitable fixing for the substrate).
- Level the back plate, and fix the other slotted hole.
- Adjust level if required.
- Insert fixings into remaining two holes.

Suitable medium to heavy duty plasterboard anchors (or equivalent appropriate fixings for the substrate) to be selected by the installer. Fixture to provide ample anchor strength, such as to allow repeated 20kg momentary forces needed to resist the pull of removing the body for maintenance.

4. Attach plug & Mount body

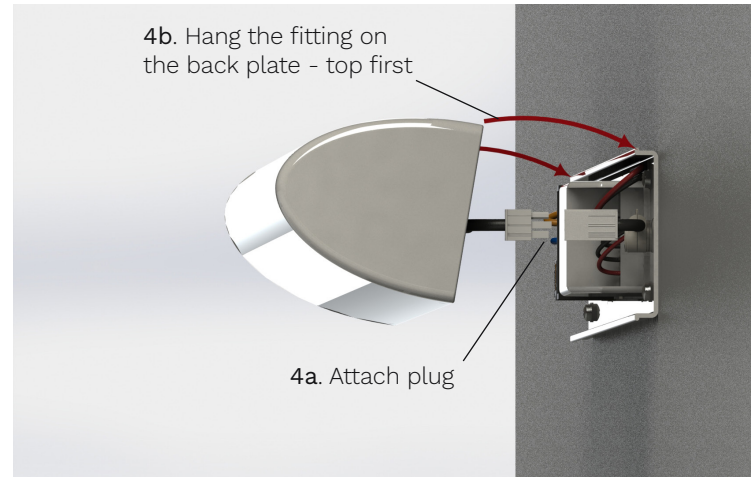

5. Clip body onto back plate

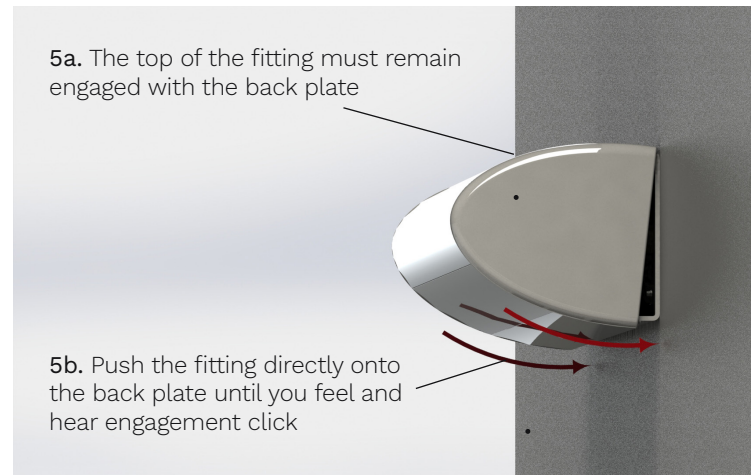

6. Tighten Locking Screws

Important:

Locking screws **MUST** be engaged.

