

[DATASHEET](#)

# PLANET **LED PUCK** SNAP LENS

An integrated LED light with a circular beam available in a range of angles. LENS is small, discreet, and its exceptionally smooth cut-off / roll-off is perfect for highlighting architectural features and controlling atmospheric lighting. Applications include jewellery, hotels, artwork and architectural.



PLANET  
**LIGHTING**



# SNAP LENS

LENS has a circular distribution with an exceptionally smooth roll-off; perfect for highlighting features and controlling atmospheric lighting. LENS is available across our range of LED Puck luminaires and available in a narrow, medium or wide beam.

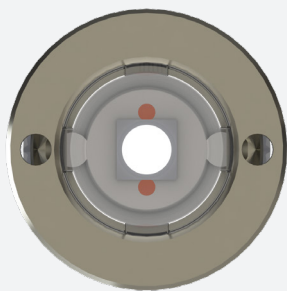

## TYPICAL SPECIFICATIONS

Product Code	Specifications
SNAP-FF-LN-30	SNAP Puck, Flat Face, Lens Narrow Beam 3000K
SNAP-FF-LM-40	SNAP Puck, Flat Face, Lens Medium Beam, 4000K
SNAP-FF-LW-40	SNAP Puck, Flat Face, Lens Medium Beam, 4000K

## SPECIFICATIONS\*

### TECHNICAL

1.4 W / 500 mA / 2.8 Vf  
CRI 80+ (CRI 90+ OPTION)  
3 Step Macadam Ellipse  
L90 B10 >100,000 hours

### LUMENS

LENS NARROW (4000K): 170lm  
LENS MEDIUM (4000K): 176lm  
LENS WIDE (4000K): 152lm

### DISTRIBUTION

CIRCULAR

### MATERIAL

316 Stainless Steel  
Electropolished

### AMBIENT OPERATING CONDITIONS

min. -40° / max. 55°

### PROTECTION CLASS

IP67

### ELECTRICAL

CoolsplICE Connector

### INSTALLATION SURFACE

min. 1.5 mm Wall Thickness

### HOLE SIZE

Ø15 mm

### COUNTERBORE

(Required for a flush finish)  
Ø16 mm x 0.5 mm  
MIN. 2mm WALL THICKNESS

### CONTROL

1-10 v | DALI | DMX | ZigBee | Casambi  
BLUE LIGHT LINK | basicDIM WIRELESS  
Blue Light Link | BasicDIM Wireless

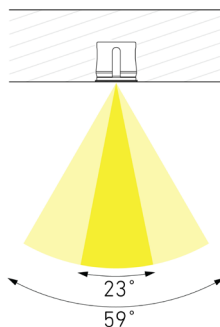

Circular distribution measured at vertical down (0°) mounting.

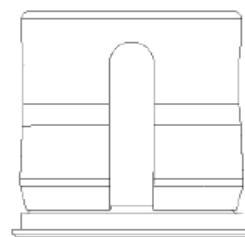

Flat Face

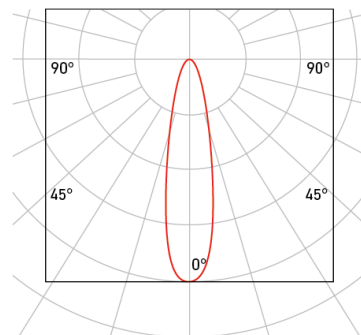

Lumens (3000K): 161m

## Ask Us.

Your success is important to us. Get in touch with your Planet LED Puck supplier today.

\*Specifications are subject to change without notice.

†Test for LED emitter at 500 mA and below 55°C ambient temp.

DATASHEET

SNAP LENS

PLANET  
LED PUCK



PLANET  
LIGHTING

### LENS NARROW

Lumens (4000K): 170lm

Beam Angle (FWHM): 23°

Field Angle: 59°

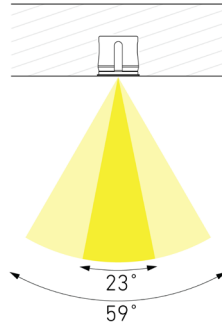

Circular distribution measured at vertical down (0°) mounting.

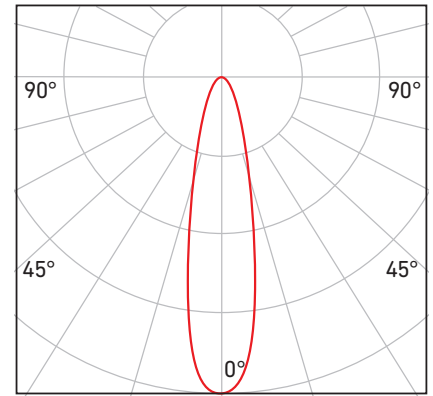

### LENS MEDIUM

Lumens (4000K): 176lm

Beam Angle (FWHM): 42°

Field Angle: 81°

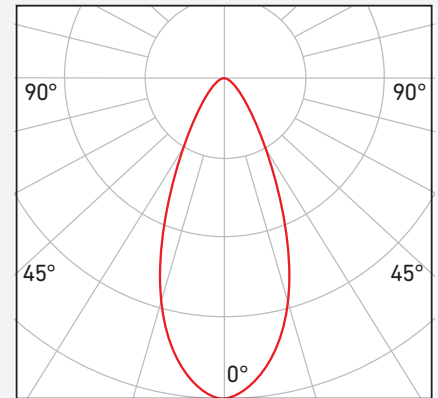
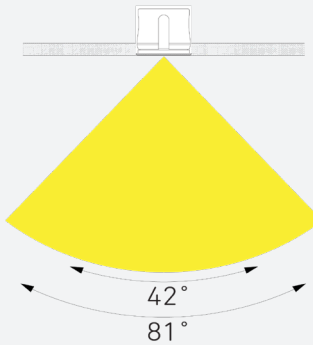

### LENS WIDE

Lumens (4000K): 152lm

Beam Angle (FWHM): 80°

Field Angle: 119°

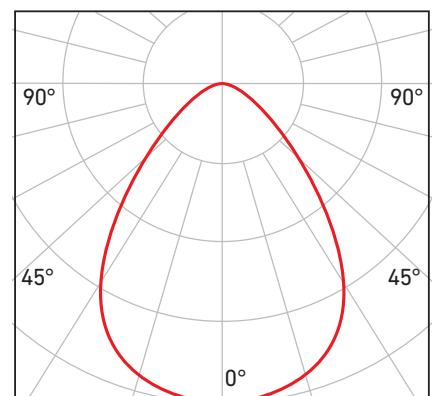
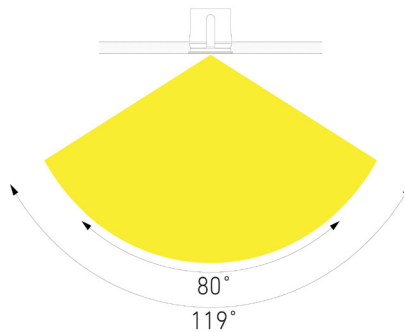

\*Specifications are subject to change without notice.



LENS PRODUCT CODE BUILDER

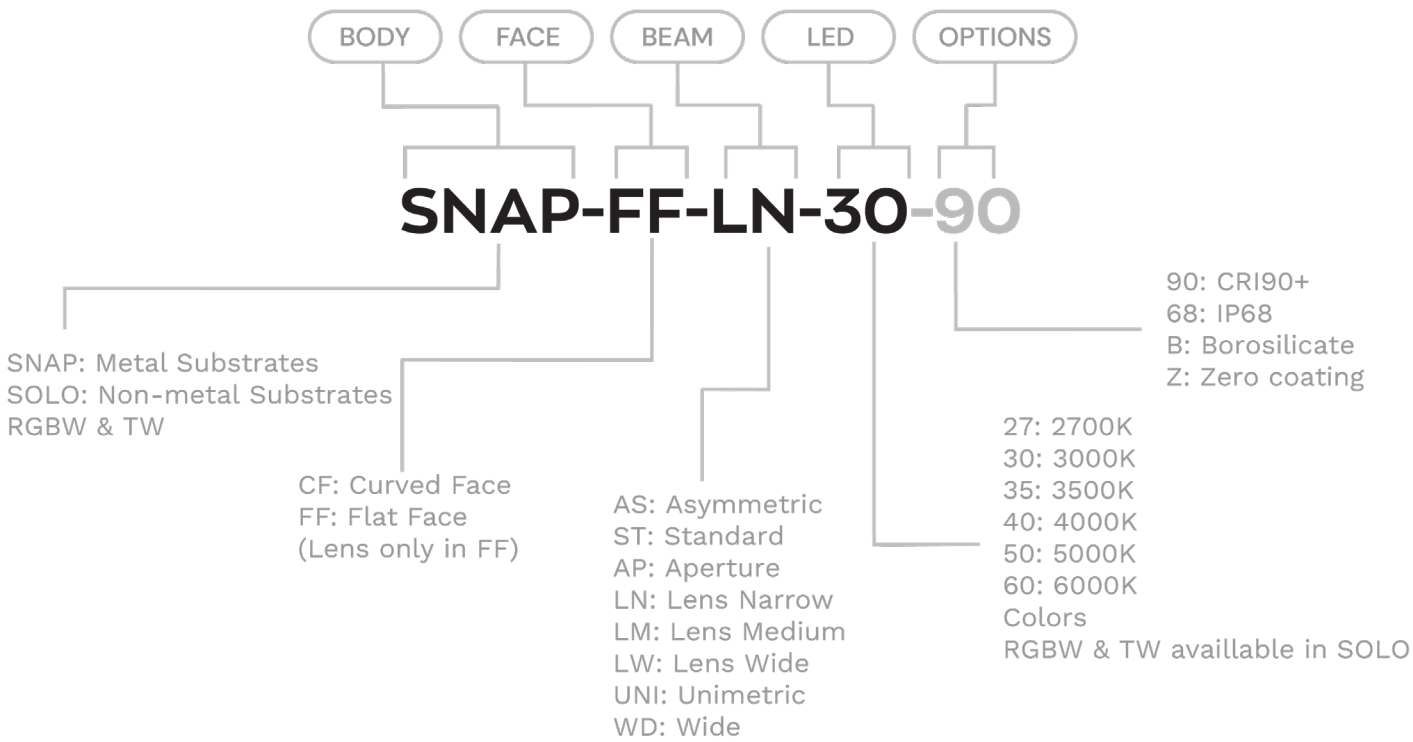

TYPICAL SPECIFICATIONS

Product Code	Specifications
SNAP-FF-LN-30	SNAP Puck, Flat Face, Lens Narrow Bream 3000K
SNAP-FF-LM-30	SNAP Puck, Flat Face, Lens Medium Beam, 3000K
SNAP-FF-LW-30	SNAP Puck, Flat Face, Lens Wide Beam, 3000K
SNAP-FF-LN-40	SNAP Puck, Flat Face, Lens Narrow Bream 4000K
SNAP-FF-LM-40	SNAP Puck, Flat Face, Lens Medium Beam, 4000K
SNAP-FF-LW-40	SNAP Puck, Flat Face, Lens Wide Beam, 4000K

