

DATASHEET

PLANET **LED PUCK**

LENS 16°

An integrated LED light with a circular beam available in a range of angles. Lens is small, discreet, and its exceptionally smooth cut-off / roll-off is perfect for highlighting architectural features and controlling atmospheric lighting. Applications include jewellery, hotels, artwork and architectural.



PLANET
LIGHTING



LED LENS 16°

Lens has a circular distribution with an exceptionally smooth roll-off; perfect for highlighting features and controlling atmospheric lighting. Lens is available across our range of LED Puck luminaires

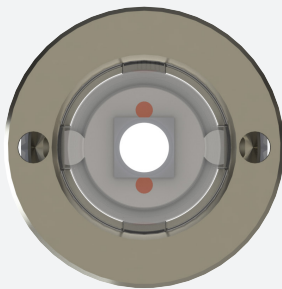

TYPICAL SPECIFICATIONS

| Product Code | Specifications |
|---------------|-------------------------------|
| LENS-16-FF-30 | Lens 16° Beam Flat Face 3000K |

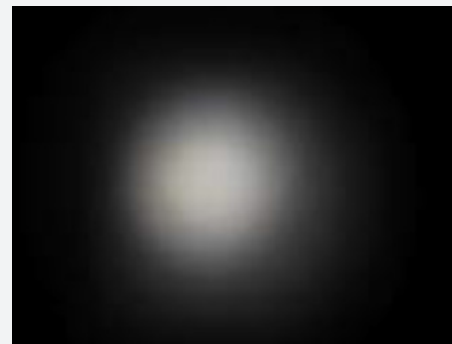
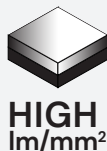

Beam Shape

SPECIFICATIONS*

TECHNICAL

1.4 W / 500 mA / 2.8 Vf
CRI 80+
3 Step Macadam Ellipse
L90 B10 >100,000 hours

LUMENS

161m

CONTROL

PMMA

DISTRIBUTION

CIRCULAR

MATERIAL

316 Stainless Steel
Electropolished

AMBIENT OPERATING CONDITIONS

min. -40° / max. 55°

PROTECTION CLASS

IP67

ELECTRICAL

CoolsplICE Connector

INSTALLATION SURFACE

min. 1.5 mm Wall Thickness

HOLE SIZE

Ø15 mm

COUNTERBORE

(Required for a flush finish)
Ø16 mm x 0.5 mm
MIN. 2mm WALL THICKNESS

CONTROL

1-10 v | DALI | DMX | ZigBee | Casambi
Blue Light Link | BasicDIM Wireless

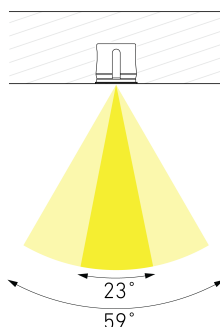

Circular distribution measured at vertical down (0°) mounting.

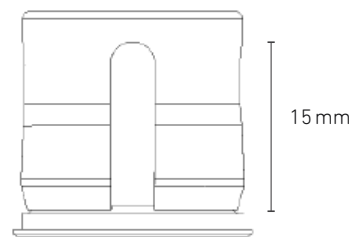

Flat Face

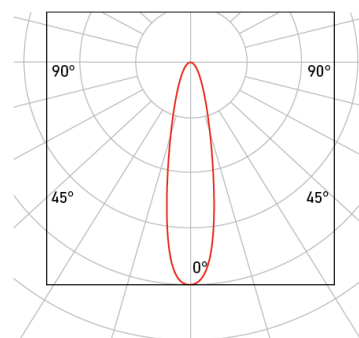

Lumens (3000K): 161m

Ask Us.

Your success is important to us. Get in touch with your Planet LED Puck supplier today.

*Specifications are subject to change without notice.

†Test for LED emitter at 500 mA and below 55°C ambient temp.

